

## STEP 2: Project or Extend Laptop Display with WSP TX

1. Power WSP TX with micro USB cable, wait until the red light turns purple.
2. Connect WSP TX to laptop HDMI port, wait until the purple light turns blue.
3. Wait and it will connect automatically.

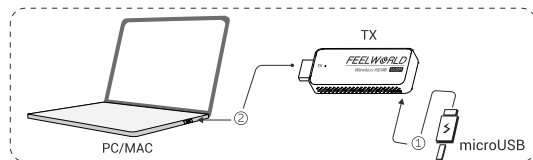

## Tips

1. A few laptops such as Thinkpad or Thinkbook, are able to power WPS TX directly from the HDMI port. To test if the laptop is able to offer power through HDMI port, customers can plug the WPS TX to the HDMI port directly without USB power supply after RX is correctly installed. Wait for around 30s, if the laptop screen is successfully streamed to the TV display, then there is no need to offer extra power by USB. If not, unplug the HDMI and power WPS TX by USB power then plug the HDMI again.



2. For laptops without HDMI port such as MacBook Air or HUAWEI MateBook, we suggest using USB-C to HDMI converter.

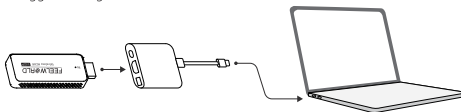

3. If USB port for power supply on the laptop is close to HDMI port, we suggest using the HDMI male to female extender cable.

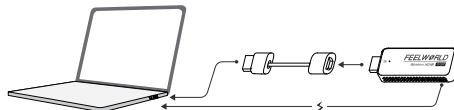

## Specification

Transmitter	
Power	MicroUSB 5V DC 500mA Max 2.5W
HDMI	HDMI 1.3
Supported Input Resolution	720x480@60   720x576@50   1280x720@50/60   1920x1080@24/25/30/50/60
Receiver	
Power	MicroUSB 5V DC 500mA Max 2.5W
HDMI	HDMI 1.3
Output Resolution	Up to 1920x1080@60

# WSP Wireless HDMI Extender Kit

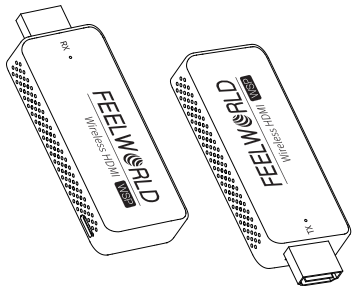

## USER MANUAL

## Overview

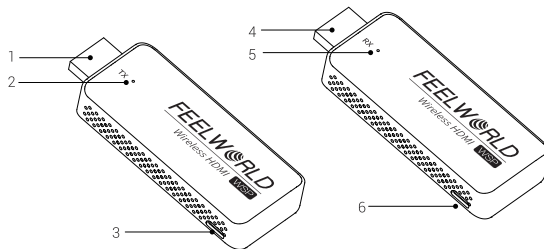

### Transmitter

1. HDMI IN (To connect source devices, like computer or other devices with HDMI, the HDMI in also support 5V power in if the source devices HDMI with 5V output.)
2. LED Indicator (To display different status.)
3. Micro USB (For power supply.)

### Receiver

4. HDMI OUT (To connect with monitor or projector.)
5. LED Indicator (To display different status.)
6. Micro USB (For power supply.)

	Status	Meaning
Transmitter	Solid Red	TX system is booting on
	Flashing Red	TX is searching for RX
	Flashing Blue	Waiting for the connection
	Static Blue	Connected and start to presenting
	Purple	No HDMI in
Receiver	Flash Blue	Waiting for connection
	Static Blue	Connected

## In the Box

Transmitter	1
Receiver	1
Micro USB Cable	2
HDMI male to female extender cable	1

## Quick Start

### System Connection Diagram

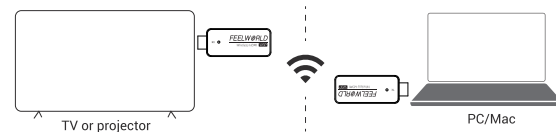

### STEP 1 :

1. Power WSP RX with the mirco USB cable
2. Connect WSP RX to TV/Projector HDMI port